

# Slide Switches

## Slide Switches (Anti-Static Electricity Type) : JSB (ASE) Series

### ■ Features

1. The product protects against the infiltration of static electricity by extending the static electricity invasion route from the operating area.
2. The product has removed the clicking sensation of a switch, allowing the customer to design their own feeling sensation.
3. Compact, low-profile slide switch with a 2 mm stroke.

### ■ Specifications

- External Dimension : 8.8 x 2.7 x 2.0mm
- Rating : DC 12V, 100mA
- Circuit : SPDT
- Life Cycle : 10,000 cycles
- Operating Force : 1N max.
- Travel : 2mm
- Packing Quantity : 1,000pcs/Pack

### ■ Product Lineup

Drawing No.	Terminal Type
JSB1220-1821F	Surface Mount Type
JSB1220-1721F	Discrete Type



**Outline Drawing : SMT Terminal  
JSB1220-1821F**

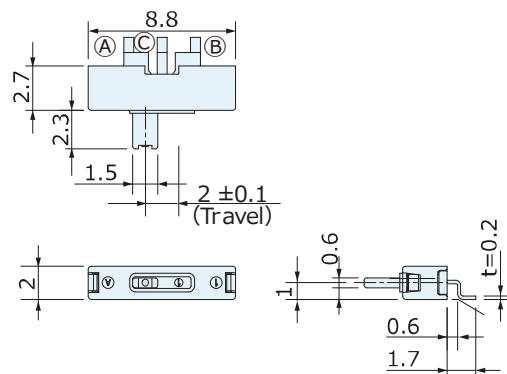

**Circuit : SPDT**

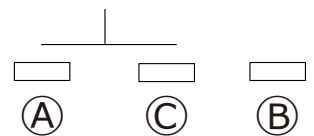

**Outline Drawing : Discrete Terminal  
JSB1220-1721F**

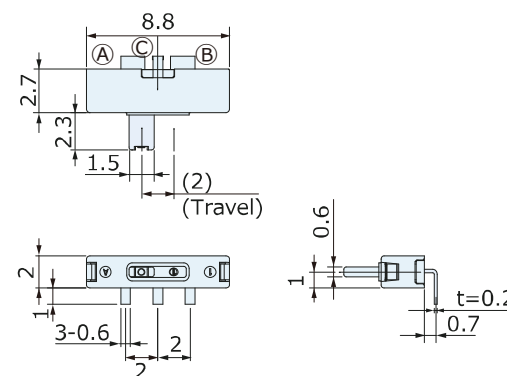

**P.C. Board Dimension**

**JSB1220-1821F**

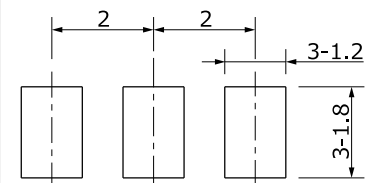

**JSB1220-1721F**

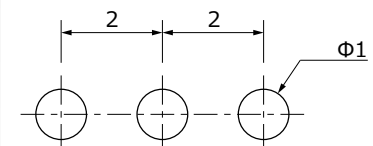

\*This product is designed for mounting with a soldering iron.