

1- Light Guide

- 1.1- Materials: PMMA
- 1.2- Finish: Polish
- 1.3- Color: Clear

2- Top Case

- 2.1- Materials: PA6 (Rigid Plastic)
- 2.2- Finish: General Polish
- 2.3- Color: Process Black

3- PCB

Electronic functions of the device.

4- Housing

- 4.1- Materials: PA6 (Rigid Plastic)
- 4.2- Finish: General Polish
- 4.3- Color: Process Black

5- Light Guide

- 5.1- Materials: PMMA
- 5.2- Finish: Polish
- 5.3- Color: Clear

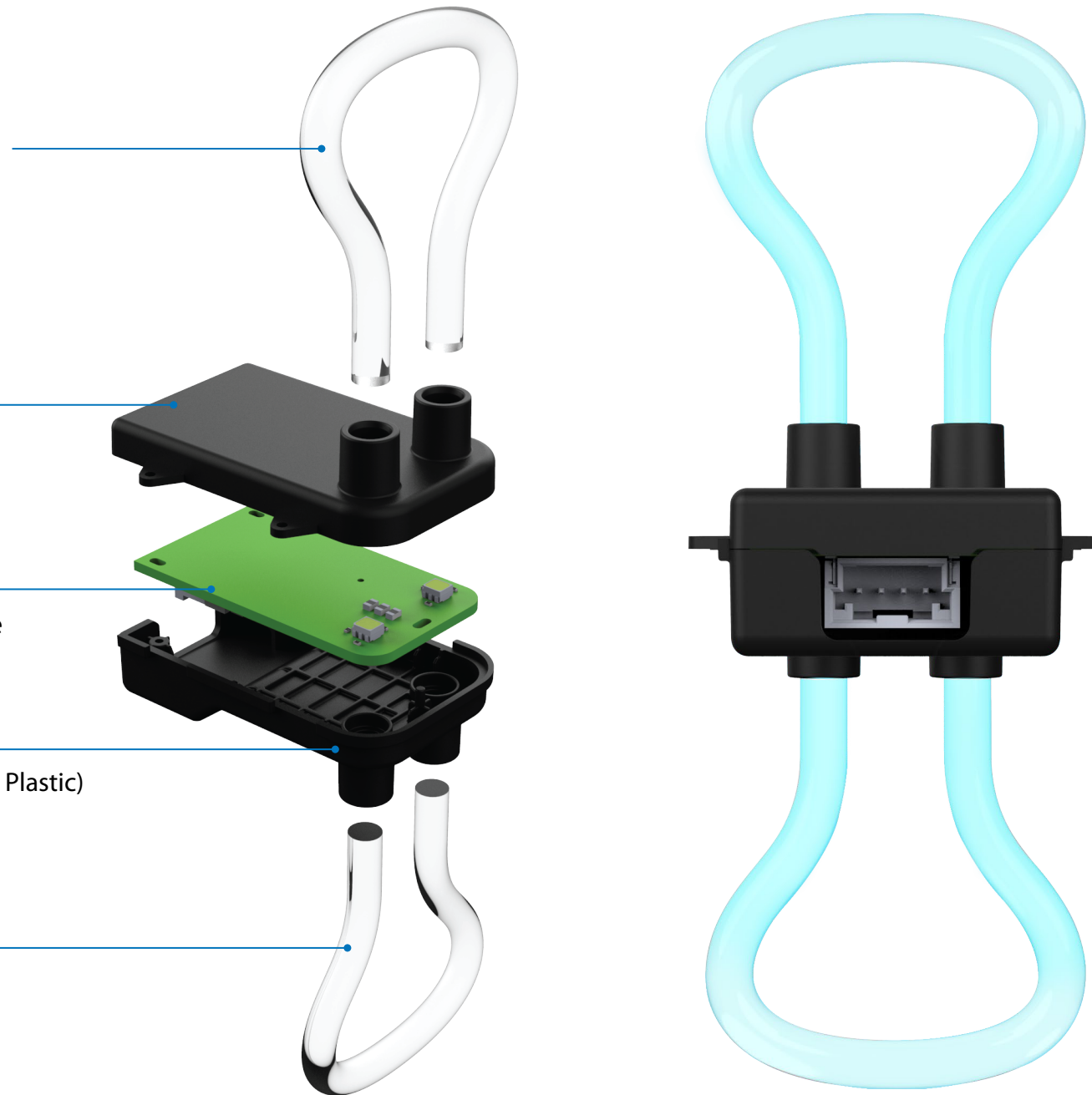

A) Description

Universal module for ambient lighting applications on automotive or home appliances. Multiple lights configurations depending lighting requirement, single or Multiple LED colors, easy to install due to compact size. Adjustable light pipe diameter.

B) Mechanical Specifications

IPXX rating upon customer requirement.

Module size: 42 x 35 x 23mm

(Two LED configuration)

Module size: 49 x 35 x 28mm

(Four LED configuration)

PCB size: 36 x 21 x 1.6mm

(Two LED configuration)

PCB size: 42 x 25 x 1.6mm

(Four LED configuration)

Right pipe diameter: 5mm

Right pipe length: 1m (Reference)

Two LED Configuration

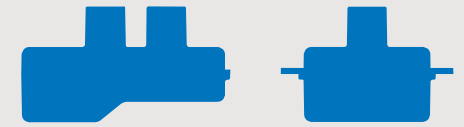

Four LED Configuration

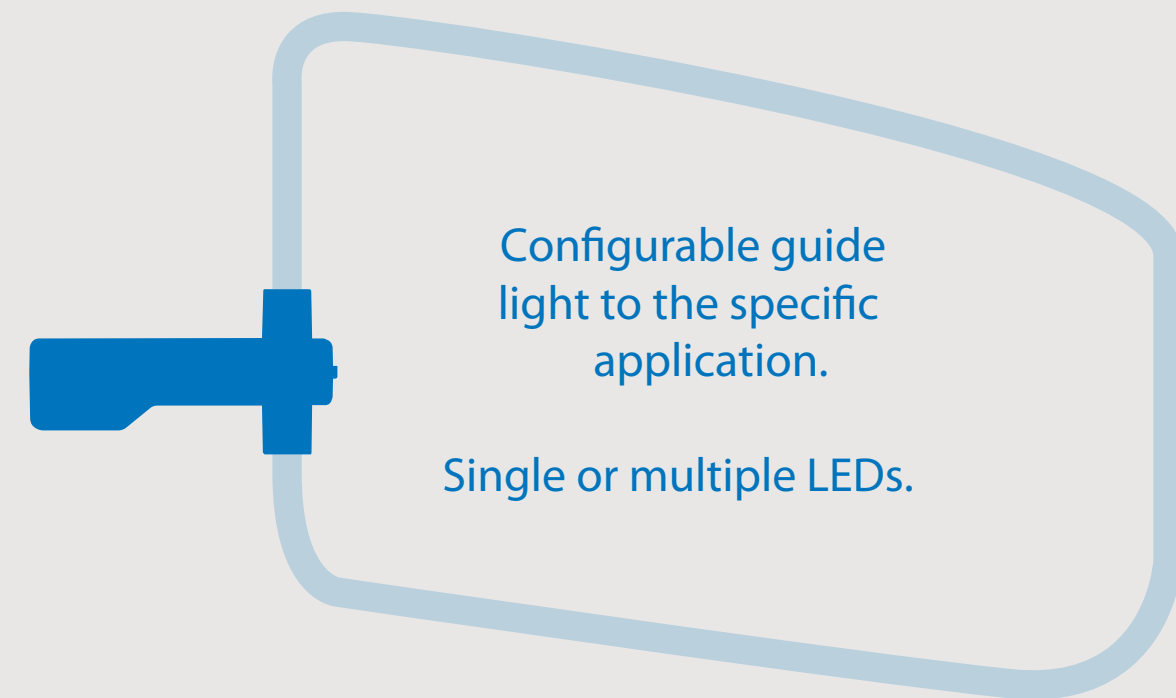

C) Electrical Specifications

Color: RGB

Power: 12V

Communication: LIN

Illuminance: 5.6 Lx (Average)/Brightness: 17.5 cd/m² (Average)

Measurement distance is 15cm

Current value: 120mA